

Prairie Points

With wrong sides together fold a square in half horizontally. Fold the folded edges toward the center as shown to create a triangle with an open fold in the center.

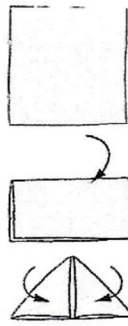

To determine the size of the cut square :
Use the height of the finished Point x $2 + \frac{1}{2}$
Example:
2"- Tall prairie point x $2 + \frac{1}{2} = 4 \frac{1}{2}$ " cut square

Quarter-Square Triangles*

With right sides together and the lighter fabric on top, pair one square of each color that makes the unit. On the lighter patch, draw a diagonal line from corner to corner.

Stitch $\frac{1}{4}$ " out from both sides of the line. Cut apart on the marked line to make 2 triangle-squares. With the darker fabric up, open out the top patch and press the unit.

Cut both triangle-squares in half diagonally as shown.

Referring to the diagram, join the appropriate halves to make 2 units.

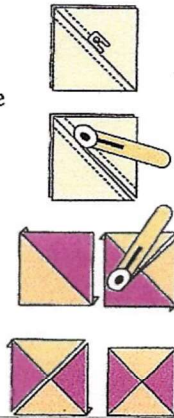

Finished quarter square triangle 2 "
Starting squares one background square
And one focus fabric square $3 \frac{1}{2}$ " each.
Trim to $2 \frac{1}{2}$ " square

Fast Flying Geese*

Align 2 small squares on opposite corners of the large square, right sides together. Draw a diagonal line as shown and then stitch $\frac{1}{4}$ " from both sides of the line. Cut apart on the marked line.

With the small squares on top, open out the small squares and press the unit. On the remaining corner of each of these units, align a small square. Draw a line from corner to corner and sew $\frac{1}{4}$ " on both sides of the line. Cut on the marked lines, open the small squares and press.

Each set of 1 large square and 4 small squares makes 4 Flying Geese.

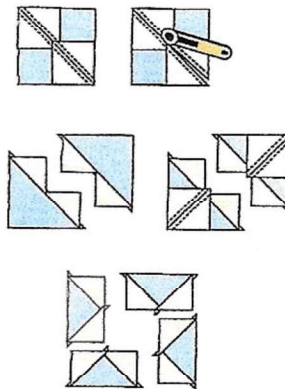

Finished Flying Geese 2x4
Cut one focus Fabric $5 \frac{1}{4}$ "
Cut 4 background fabric $2 \frac{7}{8}$ " squares

Triangle-Squares*

With right sides together and the lighter fabric on top, pair one square of each color that makes the unit. On the lighter patch, draw a diagonal line from corner to corner.

Stitch $\frac{1}{4}$ " out from both sides of the line.

Cut apart on the marked line.

With the darker fabric up, open out the top patch and press the unit.

A pair of squares will yield 2 units.

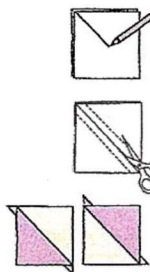

Triangles squares one focused fabric $3 \frac{1}{2}$ "
And one background fabric $3 \frac{1}{2}$ "

- For the cornerstones cut for $2 \frac{1}{2}$ "